

Rovatti Centrifugal pump cast iron DN80 x DN140 DIN flange green type T4-110 (7024361)

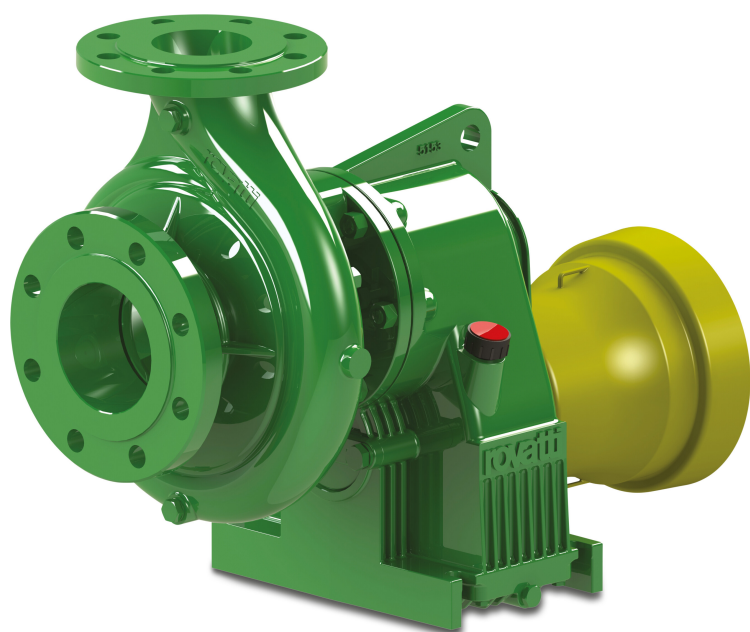

rovatti pompe

TECHNICAL SPECIFICATIONS

Colour	green
--------	-------

Material	cast iron
----------	-----------

Shaft	steel
-------	-------

Pump body	cast iron
-----------	-----------

Material impeller 1	cast iron
---------------------	-----------

Connection	DIN flange
------------	------------

Max. temperature	60 °C
------------------	-------

Impellers	1
-----------	---

Type	T4-110
------	--------

Output Power	130 HP
--------------	--------

Size	DN80 x DN140
------	--------------

MWC	140
-----	-----

Max flow rate	180 m ³ /h
---------------	-----------------------

DIMENSIONS

L	592 mm
---	--------

H-1	607 mm
-----	--------

W-1 300 mm

ØDi-1 100 mm

ØDi-2 80 mm

O 18 mm

Cb-1 277 mm

Cr-1 140 mm

G-1 270 mm

Mr 319 mm

Mc 150 mm

H 607 mm

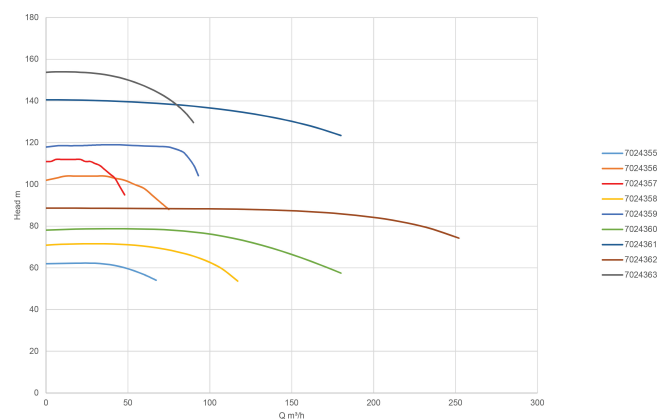
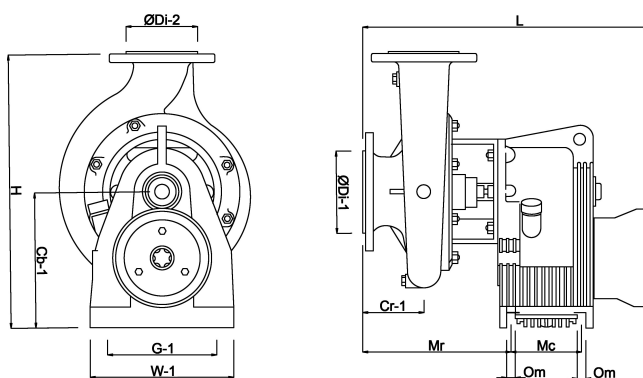

PRODUCT INFORMATION

The tractor driven pumps type T come installed with the "E" impeller which provides the highest pressure. For different impeller types please consult with us.

For the T types, the Standard Gear Ratio (PTO) has been selected. For other Gear Ratios please

consult with us. In order to choose the correct Gear Ratio with the highest efficiency we recommend to have the tractor and torque information upfront.

All the T pumps come with a lattyflon stuffing-box packing which is ideal for dirty water installation. The stuffing-box packing needs to be adjusted accordingly with the Twinner System (2 parts) so it is always leaking in order to keep it lubricated and cool.

No counter flanges are delivered with the T types, for the counter flange kits please consult with us.

The T pumps can also be delivered fully assembled: frame (available in 2 sizes), suction pipe, pressure pipe, manometer, steel valve and hand pump. Please consult with us for more information.

Applications

Medium Pressure Sprinkler Systems: types T1-65A and T2-80.

Medium Pressure Frost Protection: types T3-100A and T4-125 (max 6 and 8 ha. respectively).

High Pressure Hose Rail Machines: types T2-50, T265, T3-80A, T3K80/2 and T4-110.

Last modified date: 06/11/2025

Bosta UK Ltd.
Reflection House
Olding Road
Bury St. Edmunds
Suffolk
IP33 3TA
T +44 (0) 1284 716580
E enquiries@bosta.co.uk
<http://www.bosta.com>