

# Grundfos Multi-stage centrifugal pump stainless steel 1 1/4" 1,44A 400VAC type CRI 5-3 A CA I V HQQV (7039729)



GRUNDFOS® 

# TECHNICAL SPECIFICATIONS

Material	stainless steel
----------	-----------------

Shaft	stainless steel 316
-------	---------------------

Pump body	stainless steel 316
-----------	---------------------

Material impeller 1	stainless steel 304
---------------------	---------------------

Voltage	400VAC
---------	--------

Max. temperature	90 °C
------------------	-------

Minimum medium temperature (continuous)	-20 °C
---	--------

Temperature range	-20°C - 90°C
-------------------	--------------

Maximum ambient temperature	40 °C
-----------------------------	-------

Minimum ambient temperature	0 °C
-----------------------------	------

Type	CRI 5-3 A CA I V HQQV
------	-----------------------

Output Power	0.75 HP
--------------	---------

Size	1 1/4"
------	--------

Power	0.55 kW
-------	---------

Impellers	3
-----------	---

MWC	20
-----	----

Ampere	1,44 A
Max flow rate	8.5 m <sup>3</sup> /h
Suction	1 1/4 "
Efficiency	77,8 %
Motor RPM	2770

## DIMENSIONS

L	160 mm
H-1	475 mm
W-1	210 mm
ØDi-1	35 mm
ØDi-2	35 mm
Cb-1	50 mm
Cb-2	50 mm

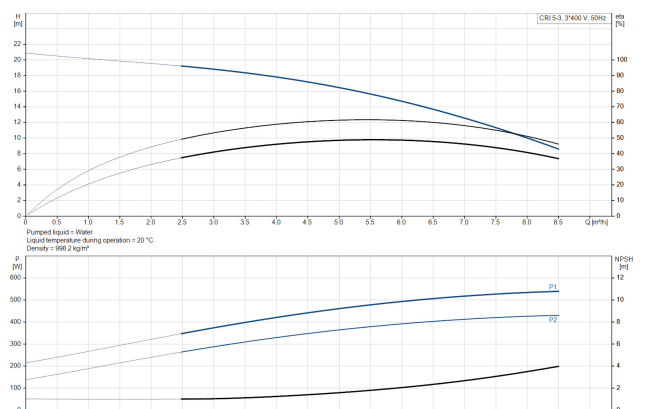
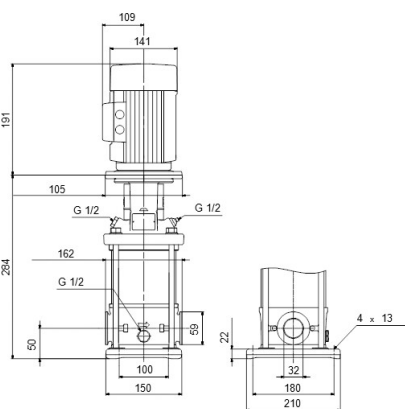

# PRODUCT INFORMATION

Grundfos CRI pumps are vertical, non-self-priming, multistage, in-line, centrifugal pumps for installation in pipe systems and mounting on a foundation, suitable for industrial applications. This design provides a more compact pump design and pipework. CR pumps are designed for a variety of applications ranging from the pumping of potable water to the pumping of chemicals. The pumps are therefore suitable for a wide range of pumping systems where the performance and material of the pump meet specific demands.

**Last modified date: 09/11/2025**

Bosta UK Ltd.  
Reflection House  
Olding Road  
Bury St. Edmunds  
Suffolk  
IP33 3TA  
T +44 (0) 1284 716580  
E [enquiries@bosta.co.uk](mailto:enquiries@bosta.co.uk)  
<http://www.bosta.com>