

**Grundfos Variable speed  
circulation pump cast iron 1  
1/2" male thread 10bar 1.33A  
230VAC black/red WRAS type  
MAGNA3 25-100 (180)  
(7039790)**



GRUNDFOS 

# TECHNICAL SPECIFICATIONS

Colour black/red

Material cast iron

Approval WRAS

Pump body cast iron

Material impeller 1 fibreglass-reinforced PES

Connection male thread

Voltage 230VAC

Max. temperature 110 °C

Minimum medium temperature -10 °C  
(continuous)

Impellers 1

Frequency 50 Hz

Maximum ambient temperature 40 °C

Pressure 10 bar

Minimum ambient temperature 0 °C

Type MAGNA3 25-100 (180)

MWC 10 m

Size

1 1/2"

Ampere

1.33 A

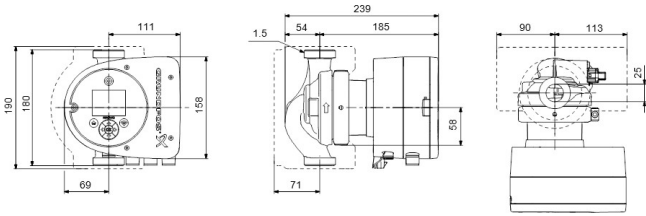

**Last modified date: 08/05/2026**

Bosta UK Ltd.  
Reflection House  
Olding Road  
Bury St. Edmunds  
Suffolk  
IP33 3TA  
T +44 (0) 1284 716580  
E [enquiries@bosta.co.uk](mailto:enquiries@bosta.co.uk)  
<http://www.bosta.com>